

Tempo *Waterfall Edge*

Tempo creates a classic, seamless waterfall edge that continues to be one of the most popular choices for a wide variety of applications. The ½" radius on the waterfall edge and backsplash provides a tighter, more contemporary look.

Tempo Waterfall Edge

The future is beyond flat. Experience VT Dimensions®

The Tempo waterfall edge profile adds dimensional beauty and character to VT Dimensions countertops. More than just a flat surface, VT Dimensions bring everything together into one seamless and contoured offering—with the depth, style, and seamless edge you want.

Experience a whole new dimension in countertops with VT Dimensions.

Specifications

- Standard substrate is 3/4" industrial-grade particleboard, available in 8', 10', and 12' lengths
- Standard postformed-grade laminate with a thickness of 0.042" + 0.002" - 0.008"
- Both standard and special styles and sizes are suitable for all residential, commercial, institutional, or light-industrial applications
- Available surfaced with Capture Collection from VT Dimensions, Formica®, Nevamar®, Pionite®, and Wilsonart® laminate
- Available as an environmentally friendly EQcountertop

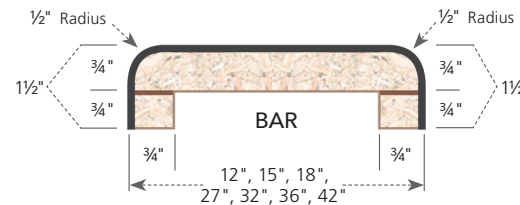
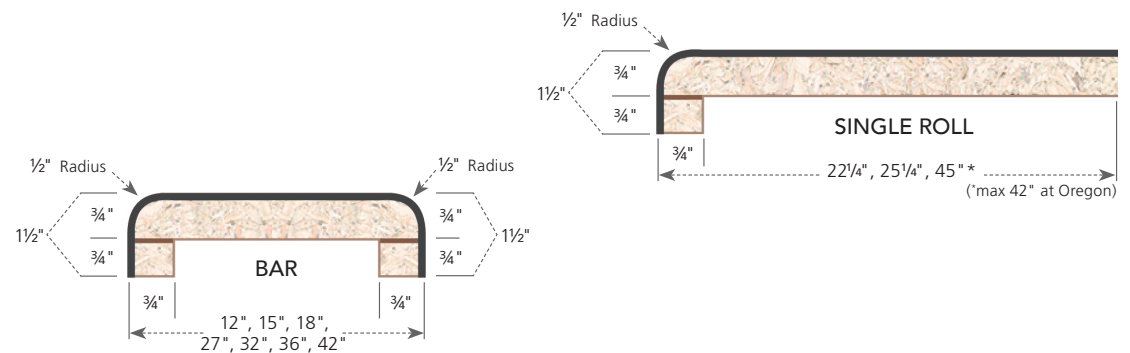
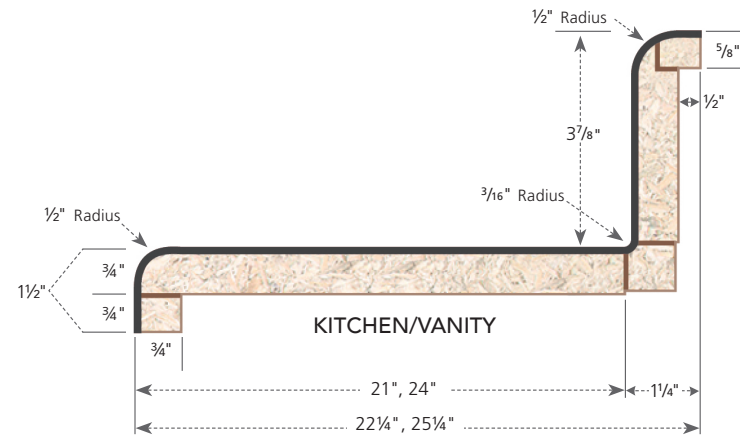

All measurements in inches. Drawings not to scale.



VTDimensions.com | 1-888-287-8356
1000 Industrial Park | P.O. Box 490 | Holstein, IA 51025

©2014 VT Industries, Inc. All rights reserved.
0521



COMMERCIAL LINE